

Welcome!

Scan the QR code with your phone to watch the installation video.



About the product

This Bridge Transceiver makes it possible to connect your Visit system to your mobile phone, tablet and Bellman's line of alerting products using Bluetooth.

What you'll need

A mobile phone with iOS 15 / Android 8 or later if you plan to connect it to your Visit system.

What's in the box

- | | |
|----------------------|-----------------|
| 1 Bridge Transceiver | 3 Power cable |
| 2 Screw and plug | 4 Power adapter |



Getting started

1. Prepare

Pull the battery tab to start the bridge.

The top indicator pulsates slowly in blue to show that it is ready for pairing.



2. Pair

- To pair the bridge with your **mobile phone**: Follow the steps on p 5.
- To pair the bridge with your **Watch Receiver**: First, charge the watch (see the user manual). Then, hold down the bridge top test button until the front LEDs blink alternately to initiate pairing.



3. Position

To optimize coverage, select a central position in the house.

Connect the power adapter and mount the bridge on the wall using the supplied screw and plug.



Finishing up

4. Test the connection

To your Visit system

- 1 Press the **bottom** test button on the bridge. The bottom LED lights up in green to show that a signal is being transmitted.
- 2 The yellow Visit LED on your receiver lights up and it starts to sound, flash or vibrate depending on the type of receiver.



Done!

Need help?

If the bridge fails to generate a notification on your receiver, you need to adjust the bridge's radio key to match your system's radio key. The radio switches are located under the front cover.

- 1 Remove the front lid on one of the transmitters to see your current radio key settings. They are marked with the symbol **RADIO** and a radio key symbol.
- 2 Remove the front lid on your bridge, set the radio key switches to the same position and put the lid back on. Test the connection by pressing the bottom test button on the bridge.

Troubleshooting

If Try this

- | | |
|---|--|
| The bottom LED blinks in green every minute | <ul style="list-style-type: none">■ It means that the bridge is running on backup battery.■ Check that the power cord is connected to mains. |
| The bottom LED blinks Intermittently in green | <ul style="list-style-type: none">■ It means that the batteries are not positioned correctly or that the backup batteries are not detected. |
| The bottom LED blinks in amber every 30s | <ul style="list-style-type: none">■ It means that the backup batteries are running low.■ Remove the front lid and replace them with two fresh 1.5V AA batteries. Put the lid back on. |
| The bottom LED blinks in red every 15s | <ul style="list-style-type: none">■ It means that the backup batteries are almost depleted.■ Remove the front lid and replace them with two fresh 1.5V AA batteries. Put the lid back on. |

Unpairing your bridge

If you want to use the bridge in another system, you need to unpair it from your current system.

- 1 Hold down both buttons for at least 6s. The top LED will start to blink rapidly in purple.
- 2 Release the buttons and hold down the top button for 3s to confirm. The top and bottom LED lights up.
- 3 Remove the power adapter and batteries to restart.

Installing the app

BE1521_050MAN9.0

1. Turn on Bluetooth®

Swipe down from the top right of the screen and tap the Bluetooth icon to turn it on.

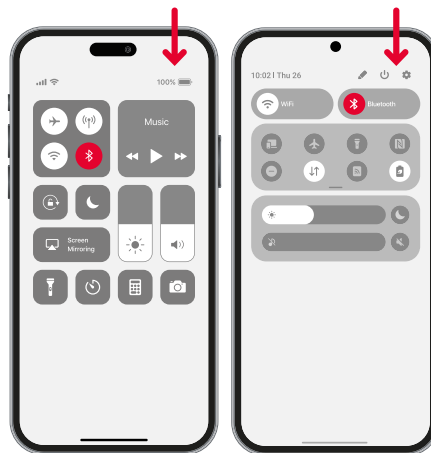

iOS

Android

2. Install the app



Download the **Assistant** app from the App Store® or Google Play™ and follow the setup instructions.



Bellman.

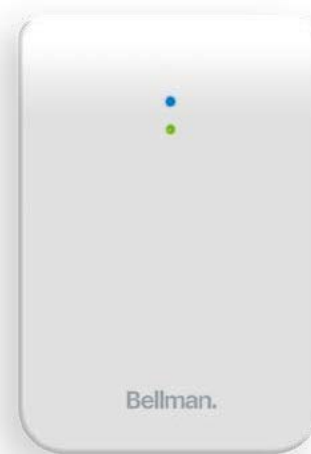

BE1521-433 Bridge Transceiver

USER MANUAL